

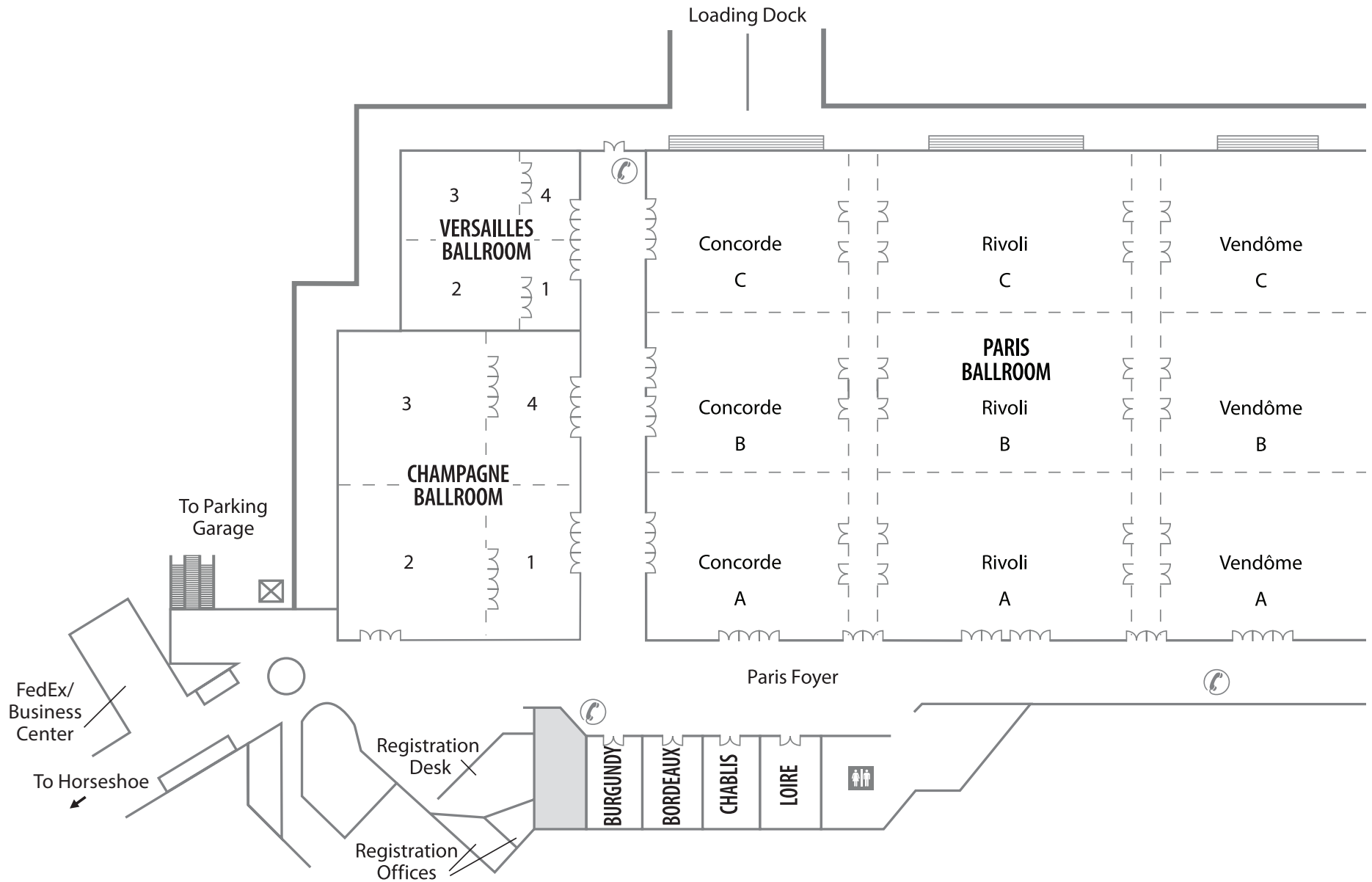

CAESARS
ENTERTAINMENT
PRESENTS

Paris[®]
LAS VEGAS

CONFERENCE CENTER



CAPACITIES AND DIMENSIONS

BALLROOMS	SQ. FT.	WIDTH	LENGTH	CEILING	CLASSROOM	THEATRE	RECEPTION	BANQUET	EXHIBITS	U-SHAPE	H-SQUARE	CONF.
Champagne Ballroom	17,464	118'	148'	20'-24'	873	1,746	1,746	1,160	—	—	—	—
Champagne 1	3,256	44'	74'	20'-24'	162	325	325	210	—	—	—	30
Champagne 2	5,476	74'	74'	20'-24'	273	547	547	360	—	—	—	30
Champagne 3	5,476	74'	74'	20'-24'	273	547	547	360	—	—	—	30
Champagne 4	3,256	44'	74'	20'-24'	162	325	325	210	—	—	—	30
Paris Ballroom	85,204	358'	238'	30'-34'	4,260	8,520	8,520	5,680	560	—	—	—
Concorde	24,514	103'	238'	30'-34'	1,224	2,451	2,451	1,630	174	—	—	—
Concorde A	8,405	103'	82'	30'-34'	420	840	840	560	—	—	—	—
Concorde B	7,725	103'	75'	30'-34'	384	772	772	510	—	—	—	—
Concorde C	8,405	103'	82'	30'-34'	420	840	840	560	—	—	—	—
Rivoli	28,560	120'	238'	30'-34'	1,428	2,856	2,856	1,900	202	—	—	—
Rivoli A	9,792	120'	82'	30'-34'	489	979	979	650	—	—	—	—
Rivoli B	9,000	120'	75'	30'-34'	450	900	900	600	—	—	—	—
Rivoli C	9,792	120'	82'	30'-34'	489	979	979	650	—	—	—	—
Vendôme	24,514	103'	238'	30'-34'	1,224	2,451	2,451	1,630	180	—	—	—
Vendôme A	8,405	103'	82'	30'-34'	420	840	840	560	—	—	—	—
Vendôme B	7,725	103'	75'	30'-34'	384	772	772	510	—	—	—	—
Vendôme C	8,405	103'	82'	30'-34'	420	840	840	560	—	—	—	—
Paris Foyer	15,670	—	—	—	—	—	—	—	—	—	—	—
Versailles Ballroom	7,569	87'	87'	15'10" – 20'	378	756	756	500	—	—	—	—
Versailles 1	1,247	29'	44'	15'10" – 20'	60	124	124	80	—	—	—	30
Versailles 2	2,545	59'	44'	15'10" – 20'	126	254	254	170	—	—	—	30
Versailles 3	2,545	59'	44'	15'10" – 20'	126	254	254	170	—	—	—	30
Versailles 4	1,247	29'	44'	15'10" – 20'	60	124	124	80	—	—	—	30
Burgundy	1,221	28'	44'	13'11" – 17'	60	122	122	80	—	38	46	30
Bordeaux	1,221	28'	44'	13'11" – 17'	60	122	122	80	—	38	46	30
Chablis	1,221	28'	44'	13'11" – 17'	60	122	122	80	—	38	46	30
Loire	1,221	28'	44'	13'11" – 17'	60	122	122	80	—	38	46	30

VERSAILLES TOWER

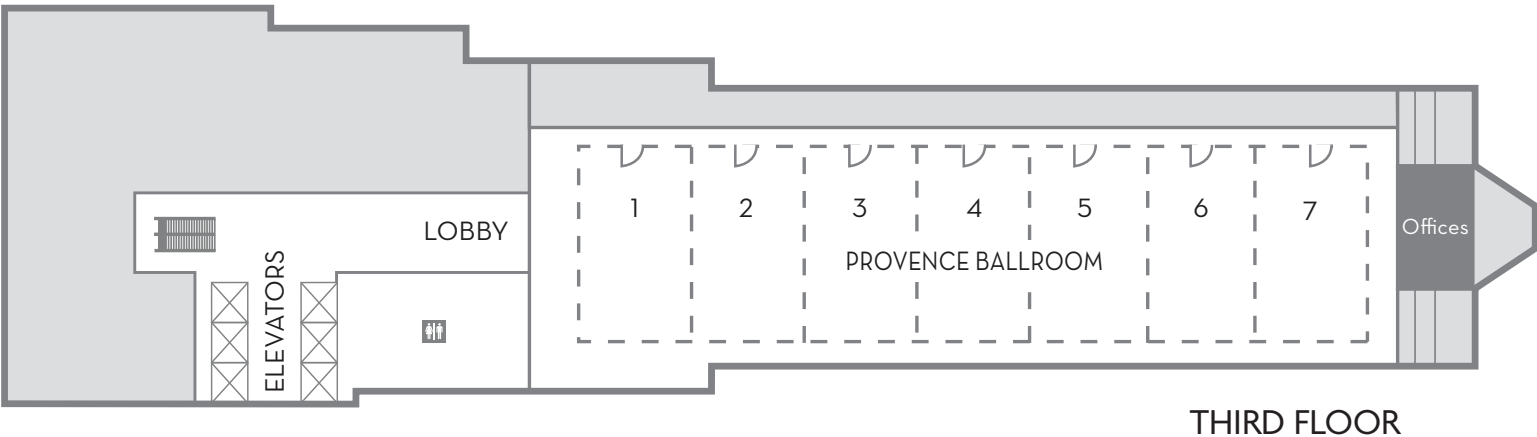
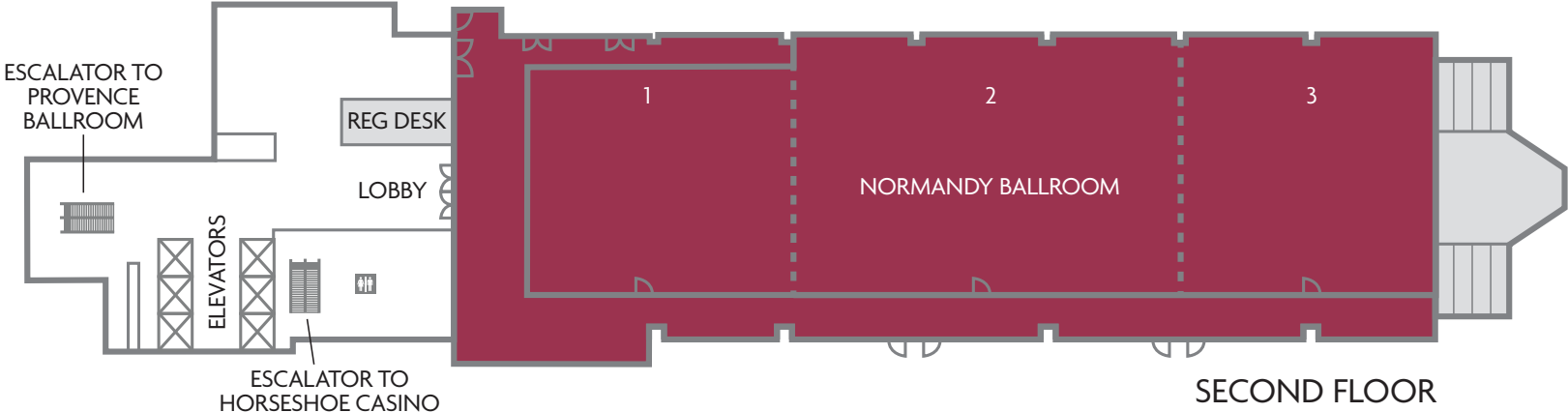

CAPACITIES AND DIMENSIONS

MEETING ROOMS	SQ. FT.	WIDTH	LENGTH	CEILING	CLASSROOM	THEATER	RECEPTION	BANQUET	EXHIBITS
Normandy Ballroom	11,733	51'-59'	208'	12' – 17'	630	1,160	1,170	690	—
Normandy 1	3,060	51'	60'	12' – 17'	160	300	300	200	—
Normandy 2	5,251	59'	89'	12' – 17'	270	530	530	350	—
Normandy 3	3,422	59'	58'	12' – 17'	210	330	340	230	—
Provence Ballroom	10,048	48'	210'	12' – 17'	771	1,004	1,004	670	—
Provence 1	1,408	30'	48'	12' – 17'	69	140	140	90	—
Provence 2	1,440	30'	48'	12' – 17'	72	144	144	90	—
Provence 3	1,440	30'	48'	12' – 17'	72	144	144	90	—
Provence 4	1,440	30'	48'	12' – 17'	72	144	144	90	—
Provence 5	1,440	30'	48'	12' – 17'	72	144	144	90	—
Provence 6	1,440	30'	48'	12' – 17'	72	144	144	90	—
Provence 7	1,440	30'	48'	12' – 17'	72	144	144	90	—



CAESARS
ENTERTAINMENT®



Find out what Caesars Entertainment can do for your business.

caesarsmeansbusiness.com • meet@caesars.com • 855-633-8238